

Referentienummer kadaster :
 Materialisatie van de grenspunten is aangeduid op het plan.
 Overige grenspunten zijn niet gematerialiseerd.
 Aanpalende eigenaars worden niet meer vermeld
 op het plan ingevolge GDPR regelgeving.

Coördinaten Lambert 1972

| Nr | X | Y |
|----|----------|-----------|
| 1 | 72791.53 | 211795.30 |
| 2 | 72810.15 | 211783.19 |
| 3 | 72841.57 | 211790.02 |
| 4 | 72837.42 | 211769.28 |
| 5 | 72835.85 | 211761.04 |
| 6 | 72807.11 | 211744.80 |
| 7 | 72822.50 | 211750.90 |
| 8 | 72817.14 | 211751.77 |
| 9 | 72832.65 | 211744.19 |
| 10 | 72839.02 | 211777.69 |
| 11 | 72847.75 | 211776.02 |
| 12 | 72850.12 | 211788.39 |
| 13 | 72833.16 | 211791.62 |
| 14 | 72836.06 | 211782.03 |
| 15 | 72825.76 | 211775.37 |
| 16 | 72827.44 | 211784.15 |
| 17 | 72792.32 | 211799.41 |
| 18 | 72778.23 | 211750.31 |
| 19 | 72795.68 | 211751.26 |
| 20 | 72784.62 | 211783.82 |
| 21 | 72793.34 | 211782.15 |
| 22 | 72810.33 | 211761.78 |
| 23 | 72823.20 | 211759.32 |
| 24 | 72821.24 | 211793.90 |
| 25 | 72800.24 | 211776.03 |
| 26 | 72801.91 | 211784.76 |
| 27 | 72811.04 | 211787.10 |
| 28 | 72785.31 | 211787.44 |
| 29 | 72791.73 | 211773.72 |
| 30 | 72788.60 | 211757.21 |
| 31 | 72786.98 | 211796.17 |
| 32 | 72791.50 | 211795.15 |
| 33 | 72796.15 | 211798.68 |
| 34 | 72794.48 | 211789.97 |
| 35 | 72795.34 | 211794.42 |
| 36 | 72802.74 | 211788.40 |
| 37 | 72804.41 | 211797.11 |
| 38 | 72793.69 | 211785.83 |
| 39 | 72812.66 | 211795.53 |
| 40 | 72811.05 | 211787.14 |
| 41 | 72783.01 | 211775.39 |
| 42 | 72808.07 | 211787.37 |
| 43 | 72819.63 | 211785.48 |
| 44 | 72779.86 | 211758.87 |
| 45 | 72792.98 | 211776.51 |
| 46 | 72792.29 | 211776.64 |
| 47 | 72781.44 | 211767.14 |
| 48 | 72792.43 | 211773.59 |
| 49 | 72790.16 | 211765.45 |
| 50 | 72788.27 | 211757.28 |
| 51 | 72786.62 | 211748.70 |
| 52 | 72796.81 | 211751.04 |
| 53 | 72788.63 | 211757.36 |
| 54 | 72804.25 | 211749.62 |
| 55 | 72796.54 | 211755.86 |
| 56 | 72808.49 | 211774.47 |
| 57 | 72796.03 | 211746.88 |
| 58 | 72797.18 | 211760.01 |
| 59 | 72805.90 | 211758.35 |
| 60 | 72810.29 | 211783.16 |
| 61 | 72808.63 | 211774.44 |
| 62 | 72818.05 | 211777.25 |
| 63 | 72809.48 | 211778.89 |
| 64 | 72816.43 | 211768.67 |
| 65 | 72819.39 | 211780.01 |
| 66 | 72818.83 | 211777.10 |
| 67 | 72810.90 | 211787.13 |
| 68 | 72818.61 | 211780.16 |
| 69 | 72824.07 | 211741.56 |
| 70 | 72823.03 | 211753.68 |
| 71 | 72815.50 | 211743.20 |
| 72 | 72808.74 | 211753.38 |
| 73 | 72822.47 | 211750.75 |
| 74 | 72822.15 | 211753.85 |
| 75 | 72814.60 | 211760.96 |
| 76 | 72813.00 | 211752.57 |
| 77 | 72834.50 | 211773.78 |
| 78 | 72831.54 | 211783.23 |
| 79 | 72836.14 | 211782.36 |
| 80 | 72808.13 | 211787.67 |
| 81 | 72848.44 | 211779.67 |
| 82 | 72839.88 | 211781.30 |
| 83 | 72846.93 | 211767.48 |
| 84 | 72844.57 | 211759.37 |
| 85 | 72841.36 | 211742.54 |
| 86 | 72842.99 | 211751.12 |
| 87 | 72834.28 | 211752.78 |
| 88 | 72846.14 | 211767.63 |
| 89 | 72847.53 | 211770.62 |
| 90 | 72846.74 | 211770.77 |
| 91 | 72831.57 | 211783.38 |
| 92 | 72796.39 | 211755.89 |
| 93 | 72825.74 | 211750.28 |
| 94 | 72807.71 | 211770.34 |
| A | 72773.28 | 211750.07 |
| B | 72843.57 | 211734.75 |
| C | 72854.75 | 211793.56 |
| D | 72784.94 | 211805.53 |

107/A

107/G

116/B

116/B

112/L2

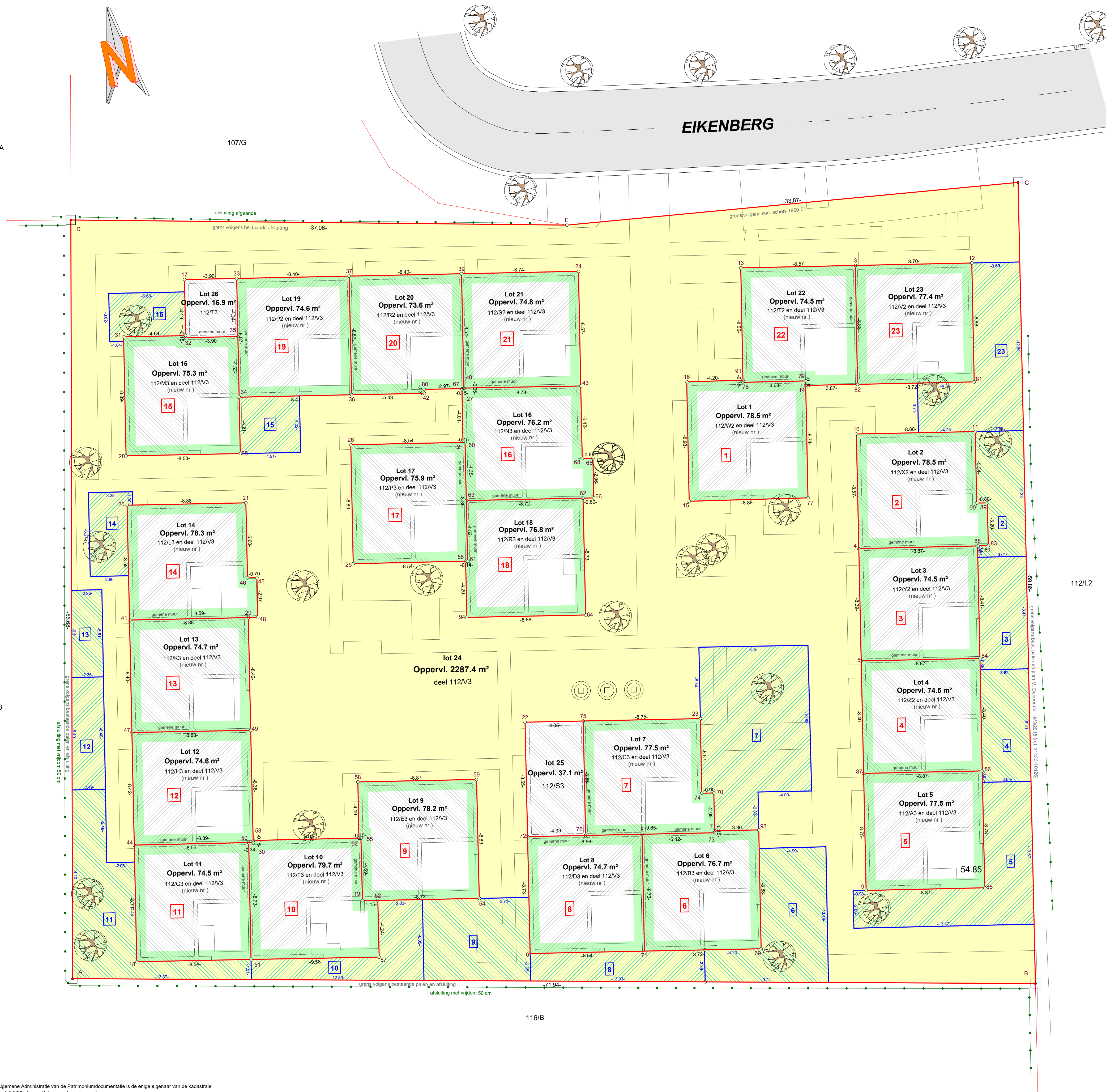

Opgemaakt te Roesbrugge-Haringe
 op 19 juni 2024

Ameloot Eddy
 Landmeter-expert, beëdigd door
 de Rechtbank van Eerste Aanleg
 van Veurne
Molenwalstraat 13
8972 Roesbrugge-Haringe
 Tel: 057/301242
 Gsm: 0475/918315
 e-mail: eddy@ameloot@telenet.be
 LAN 04 0025

Schaal 1/150

* © De Algemene Administratie van de Patrimoniumdocumentatie is de enige eigenaar van de kadastrale gegevens 1.1.2023 die op dit document voorkomen.

Coördinaten Lambert 1972 en hoogtes TAW zijn bepaald aan de hand van GNSS opmeting met FLEPOS-correctie. Bij de interpretatie van dit plan dient hiermee rekening gehouden te worden.